



**Politecnico
di Torino**

Honors Thesis

Master's Degree Architecture for Sustainability.

Abstract

URBAN RECONCILIATION

Design strategies for the "Case Parcheggio" in the Tamburi district of Taranto

Tutor

Santiago Emanuel Gomes

Candidate

Agostino Ruggiero

February 2025

Through the heritage of public housing (ERP) in the Italian context, as well as in the European one, it is possible to construct a highly detailed narrative of the evolution of living and cities, driven by the relentless progress of society over the last century. This legacy often characterizes marginal, peripheral areas of cities, enclaves where public intervention struggles to operate and engage, thereby widening the physical and social divide between these areas and the city itself. The rehabilitation of public housing in Italy is a particularly relevant topic today, driven by the need to meet new contemporary housing standards while challenging the long-established domestic spaces.

This thesis project focuses on the case of the “Case Parcheggio” in the Tamburi district of Taranto. Built as temporary public housing between 1980 and 1981, these buildings are now a focal point of social and physical segregation, as well as housing distress within the neighborhood. Political authorities and the managing body, Arca Jonica, plan to demolish these nine buildings and construct new housing in other district (including Salinella and Paolo VI districts) relocating their residents.

The proposed project aims to offer an alternative vision rooted in the reconciliation of urban space with residential space and its inhabitants, defining a phased rehabilitation plan. The adopted strategies are designed as replicable and adaptable tools for different contexts, providing an alternative to the demolition and reconstruction of new public housing buildings. This approach focuses on the care and regeneration of the place, aiming to “reweaving” the urban fabric and its community.

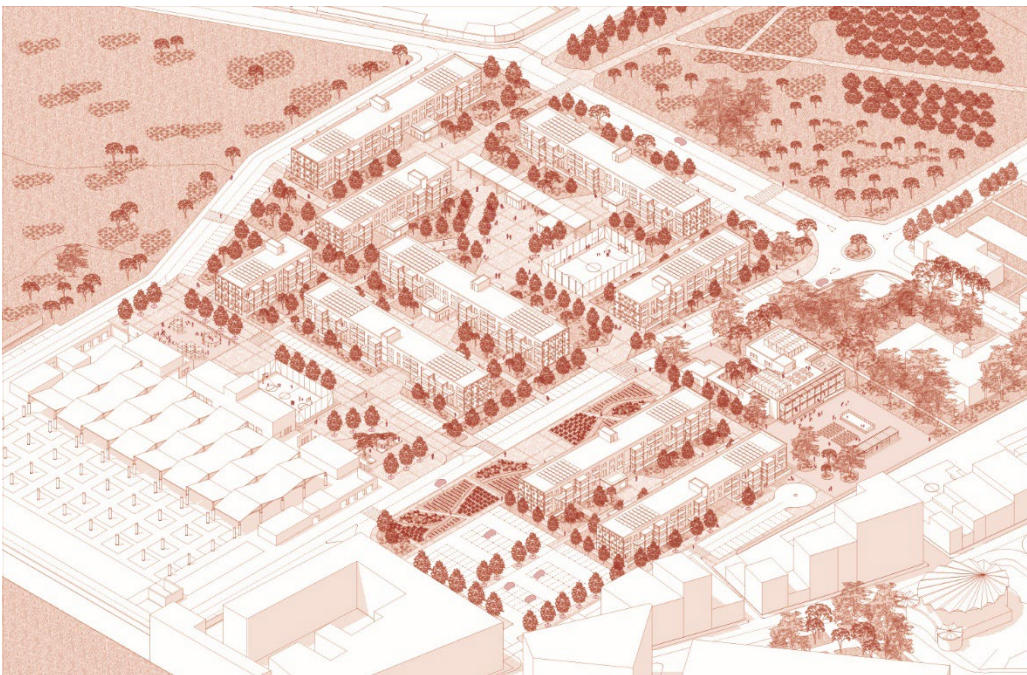

For info:

agostinoruggiero98@gmail.com