

POLYTECHNIC OF TORINO  
FACULTY OF ARCHITECTURE 2  
Degree in Architecture  
*Honors theses*

---

**Film and television studios in the former mining area of Monteponi near Iglesias**

by Alessandra Pau

Tutor: Giacomo Donato

Co-tutor: Luciano Ottelli

The study undertaken repropose the reconversion of several infrastructures which were part of the dismissed mine of Monteponi, located in the municipality of Iglesias, a historical town situated in the Sulcis region of south-west Sardinia.

The aim of the project is give a new shape and use to the building complex which originally housed the activities for the supply of tools and plant to the primary mining activity and the working of the minerals.

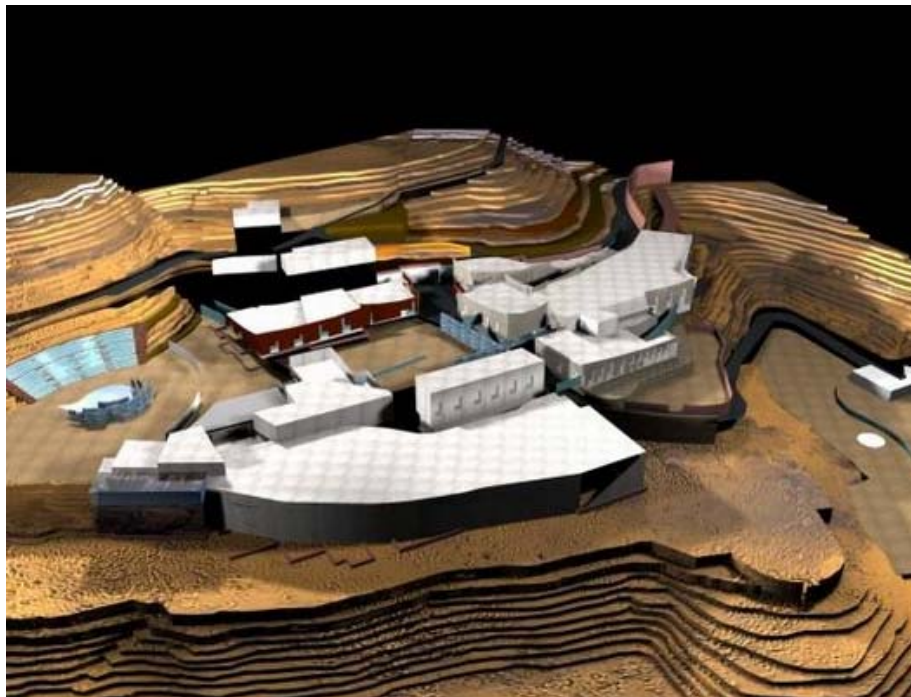

General view of the complex

The project is inspired by logic of trying to safeguard the historical industrial heritage by maintaining the perimeter walls, to a height of about 60 cm., as a trace of its existence. Within the “walls”, new buildings take shape – their structure being aimed at matching two distinct needs: the regular shape of the existing buildings and the development of curves that reflect the morphological characterisation of the hill on which the mining complex is located. These are accentuated by the curves of the slag-heaps (the “Red Sludges”) that are set into the surrounding Mediterranean maquis, conferring a strange chromatic effect.

Each building is characterised by two planning solutions that take on as distinctive features:

- the layout of L-shaped windows that jut out from the façade;
- sail-like wrought iron nets, placed in front of the perimeter walls, with the purpose of giving the building a curved look and at the same time a dynamic effect to the regular shape of the buildings behind.



View of the complex and inside the theatre

The centrally located film and television studios are connected directly to the theatre and are equipped with multifunctional equipment for audio and video editing, virtual sets, offices and conference rooms.

Furthermore, there is an open-air amphitheatre, set in the surrounding hill, for hosting shows in the summer period. Its circular shape insists on the basic idea that the plan is founded on, namely creating a fulcrum for the top of the buildings.

Finally a new kind of access is proposed through its new layout inside the entry yard, which at present is closed between different buildings.

At the same time a new road system is planned with a view to avoiding vehicle traffic from interfering with pedestrian walkways inside the complex housing the studios, thus assuring unhindered accessibility.

Ample car parks are located outside but offering easy access to the various areas of the complex and the external road network.



View of the television studios with the iron nets and L-shaped windows

The proposed intervention is aimed at a radical re-layout of the existing complex, which is on the other hand conditioned by an advanced state of decay, and at offering innovative solutions that seem to be compatible with the framework and with the recovery works of other buildings, included once again in the same context and recently earmarked as university buildings or logistic solutions suitable for hosting cultural events, conferences and exhibitions.

The project is set in a currently depressed socio-economic situation, in which major entrepreneurial initiatives are lacking, where there is the need to invent solutions suitable for effectively revitalising and conferring added value to the special geological, historical and environmental heritage of the entire area, by broadening the horizons of tourist initiatives which up to now have been focused almost exclusively on hotel activities, along the coastal areas for which the island is best known.

For further information, e-mail:  
Alessandra Pau: [alepau@fastwebnet.it](mailto:alepau@fastwebnet.it)