



**Politecnico
di Torino**

Honors Thesis

Master in Architecture Heritage Preservation and Enhancement

Abstract

**Intervening on the Stupinigi Concentric. The Podere Sperimentale as an example
of reactivation of rural architecture**

Tutor

Silvia Gron

Correlator

Cristina Coscia

Candidates

Chiara Cavanna
Isabella Ciminiello
Simone Nardi

February 2023

Italy has always been defined as an "open-air museum" due to the complexity of the elements that make up its cultural heritage: museums, theatres, archaeological sites, historic palaces, protected nature reserves and the 58 UNESCO sites make up the mosaic of Italian heritage, constituting a unicum on the world scene. Although the related activities created by the artistic-cultural heritage represent 17.2% of the national GDP, the field of cultural heritage still appears not completely developed in its potential, the result of the difficulty of their management, which also translates into the greater valorization of some reality than others. An example of this is the Palazzina di Caccia di Stupinigi with its Concentrico which includes the farms. It is still in the background compared to the nearby Reggia di Venaria, despite being one of the main residences of the Savoy. The condition of Stupinigi and its farms, together with the increase in the demand for gentle and rural tourism, which occurred after the Covid-19 pandemic, were the first points of reflection that made the place the focus of the thesis work . With the project proposal we want to respond to various problems. First of all the need to generate value by creating a network of territorial collaborations: Stupinigi, at the center of six Municipalities, must both act as an attracting focus for the context and exploit its peculiarities. Furthermore, today's issues related to the increase in food needs, food quality and water scarcity have meant that there was the need to have to respond, through the rediscovery of ancient crops, with agricultural technologies capable of employing, in more cautiously, the territorial resources. The transformation of the San Giuseppe and Santa Margherita farms into a single experimental farm (called Podere Sperimentale) intends to be a proposal applicable to similar realities located on the national territory. The reactivation of farms is not only a means of territorial development, but a way to raise awareness of the benefits of new, more sustainable cultivation techniques and to give new importance to georgic places.



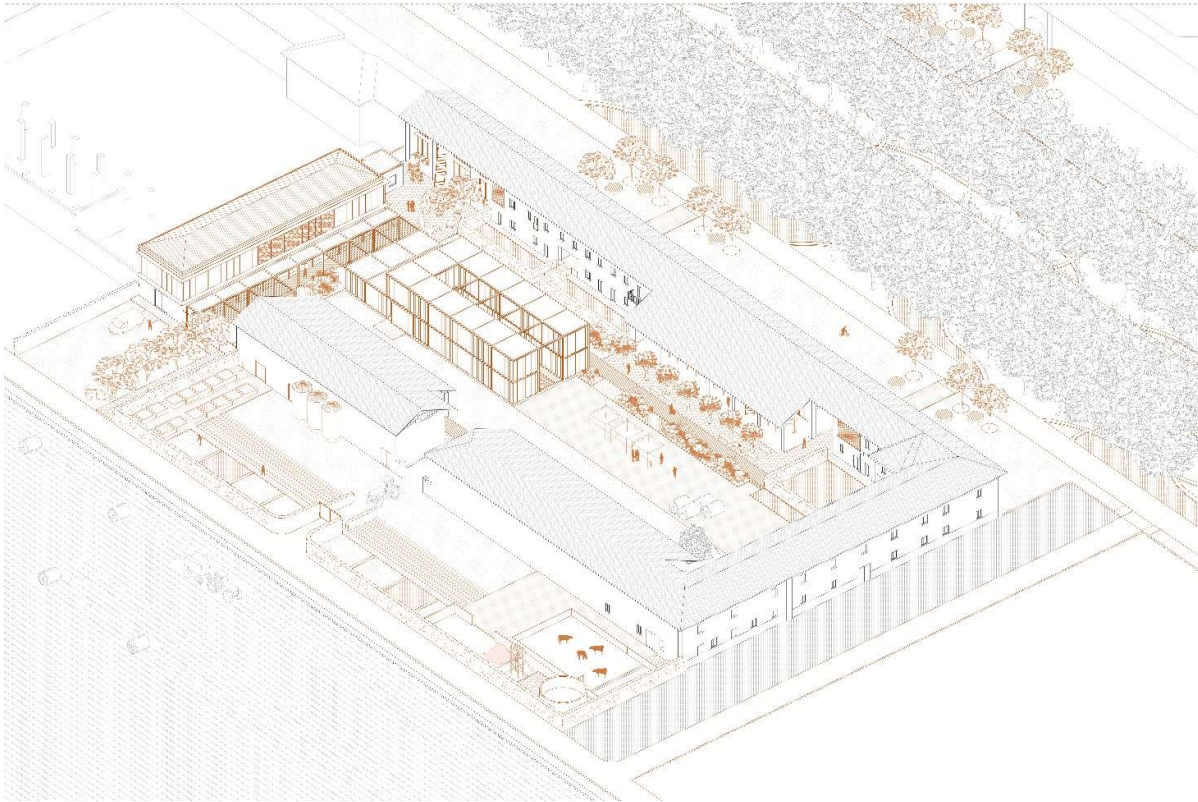

For info:

isabellaciminiello@gmail.com

chiaracavanna.uni@gmail.com

simonenardi@me.com