



**Politecnico
di Torino**

Honors Thesis

Master of Science in Architecture Construction City

Premise. The reference context of the thesis work is that of the QUICHE research project (acronym for the departmental project "Which measurements for which policies. Towards the Sustainable Development Goal 11" of the Interuniversity Department of Territorial Science and Politics, referent Prof. Isabella M. Lami) which proposes a rethinking of the concept of sustainability in its urban dimension in the light of the pandemic we have known in the last year. The research focuses on three Targets of Goal 11 of the 2030 Agenda for Sustainability of the United Nations: 11.1, Affordable housing; 11.3, Inclusive and Sustainable Urbanization; 11.A, Strong National and Regional Development Planning. Our thesis work is grafted on the reflection around Target 11.1 (Affordable housing) "By 2030, guarantee everyone access to adequate, safe and affordable housing and basic services and redevelop poor neighborhoods".

The emergency we are experiencing, due to the Covid-19 pandemic, has highlighted the pre-existing social inequalities, amplifying them, and has made issues relating to the housing problems of the most fragile subjects even more evident. Therefore, the improvement of public housing today plays a fundamental role in terms of social sustainability and in achieving the United Nations Sustainable Development Goals, in particular Objective 11.

The physical distancing to which we were forced - which in fact was social - has in contrast strengthened the will to share and socialize and this is reflected in the physical space, which must know how to adapt to new needs to accommodate them, allowing to maintain sociality even in case the need for physical distancing reappears.

Target. Starting from the identification of the needs and criticalities that emerged in the residential sector during the pandemic and from a reflection on the indicators of Target 11.1, the thesis intends to develop a proposal for increasing social sustainability, addressing some qualitative aspects (and not only quantities) of

living. To achieve this goal, on the basis of theoretical reflections, we move on to the practical act of redesigning a case study chosen from the public residential building heritage, through an action of spatialization of the needs that emerged, intervening on the livability and quality of dwellings in relation to the external spaces pertaining to the buildings. These places (internal courtyards, gardens, roofs, resulting spaces) often underutilized or undervalued can become, if properly designed, a place of sharing, an extension of the living space, thus implementing the quality of life in general and consequently becoming a tool of social sustainability.

Affordable Housing and Pandemic.
New needs and Target 11.1: from measurement to design

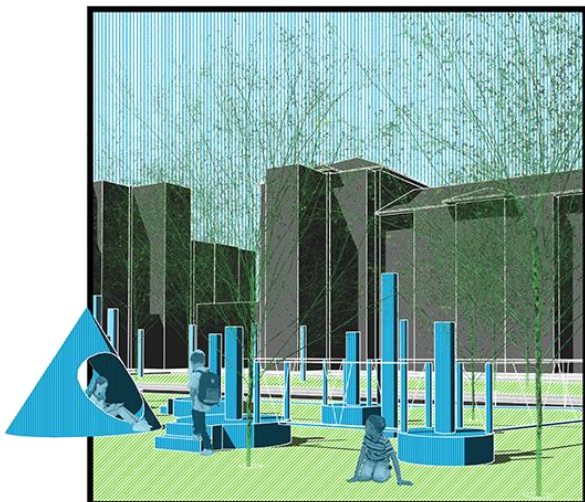

Tutor

Isabella Maria Lami
Manfredo Nicolis di Robilant

Candidate

Sara Giardino
Chiara Guastalegname

July 2021

For info:

sg.saragiardino@gmail.com; chiaraguastalegname@outlook.it