

POLITECNICO DI TORINO  
SECOND SCHOOL OF ARCHITECTURE  
Master of Science in Architecture  
***Honors theses***

---

**Self-built house with pallets. A house for roma people**

by Elena Candelari

Tutor: Nuccia Maritano Comoglio

Co-tutor: Ignazio Caruso

This thesis proposes to build a living unit using, as basic material, wooden pallet, an object that is often discarded after a single cycle of use. This project is made for the Roma families of Turin that today still live in shacks and precarious housing situations.



Gipsy camp in via Germagnano, Turin

The use of reclaimed materials, used with simple technologies that enable the self-construction is fundamental not only to safeguard the environment and avoid unnecessary waste in a sustainable perspective, but it's what allows to engage people in building the house, and to start, by working together, to cross a bridge between different cultures.

Indeed, the use of these "new" materials, through systems that must be invented, reduces the component of prefabrication and specialization necessary for building, and amplifies self-construction.

For this reason, these systems allow the use of architecture as a tool of relation between designers and recipients, between project managers and builders.

So that we can reach a second goal: the work of design and construction, held in "duet" together with the Roma families, will be an opportunity to begin dialogue and it will start a relation, made of co-working and collaboration.

The design of a living unit for Roma families living now in shacks and spontaneous settlements is the expression of one of the possible applications of the construction system in pallets.

A project addressed to a complex and multifaceted context, rich in nuances and diversity; the proposed solution, a living module with pallets and other recycled materials, attempts to capture this complexity and to give it value.

It's a flexible and modifiable project because of the versatile and multifaceted background of gipsy camps, authorized or unauthorized.

It's a project made up by meeting, dialogue and listening, involvement and mutual exchange.

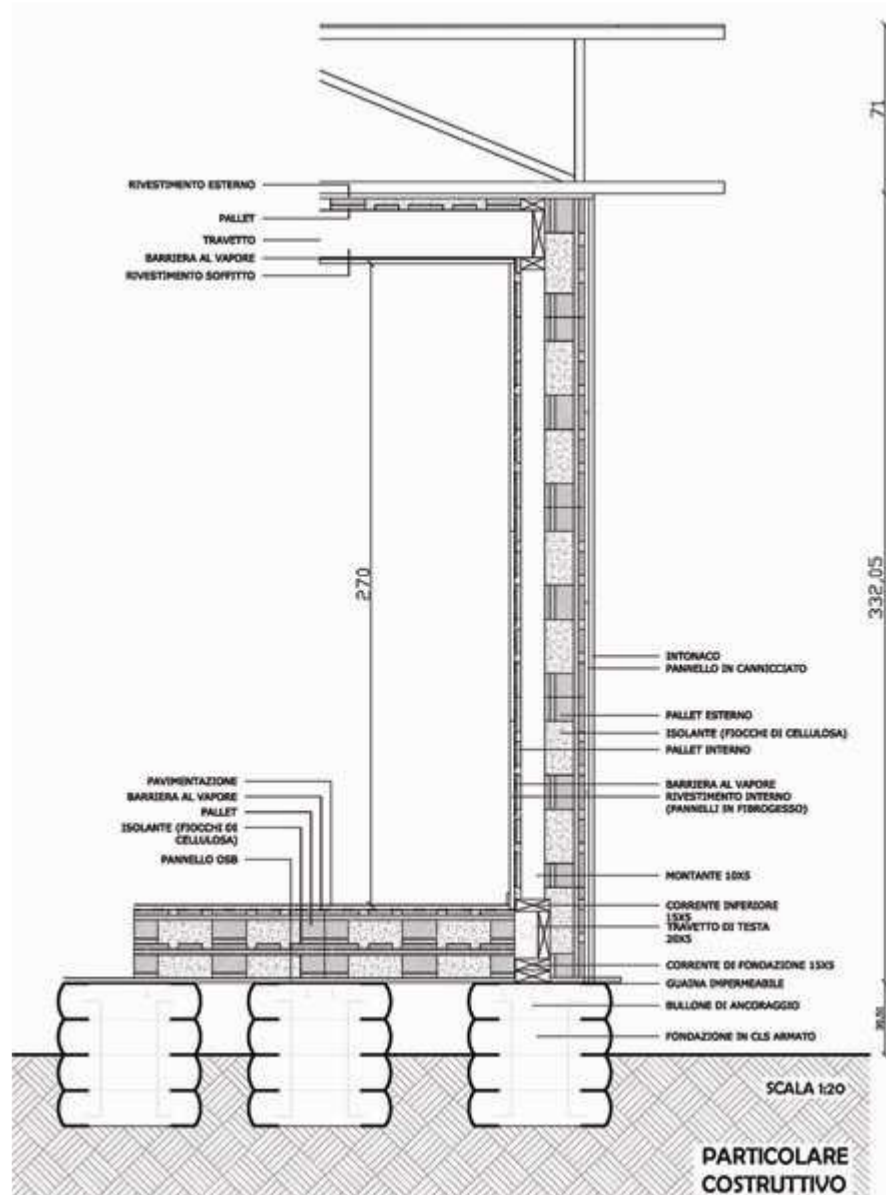

Technology for pallet construction



Scale model

For further information, e-mail:  
Elena Candelari: [candelena@libero.it](mailto:candelena@libero.it)