

POLITECNICO DI TORINO
SECOND SCHOOL OF ARCHITECTURE
Master of Science in Architecture
Honors theses

Redevelopment of archaeological site

“Albintimilium: the rediscovery of lost steps...”

by Valentina Bruno

Tutor: Paolo Mellano

Co-tutors: Mauro Luca De Bernardi and Gian Piero Martino

Introduction and historical notes

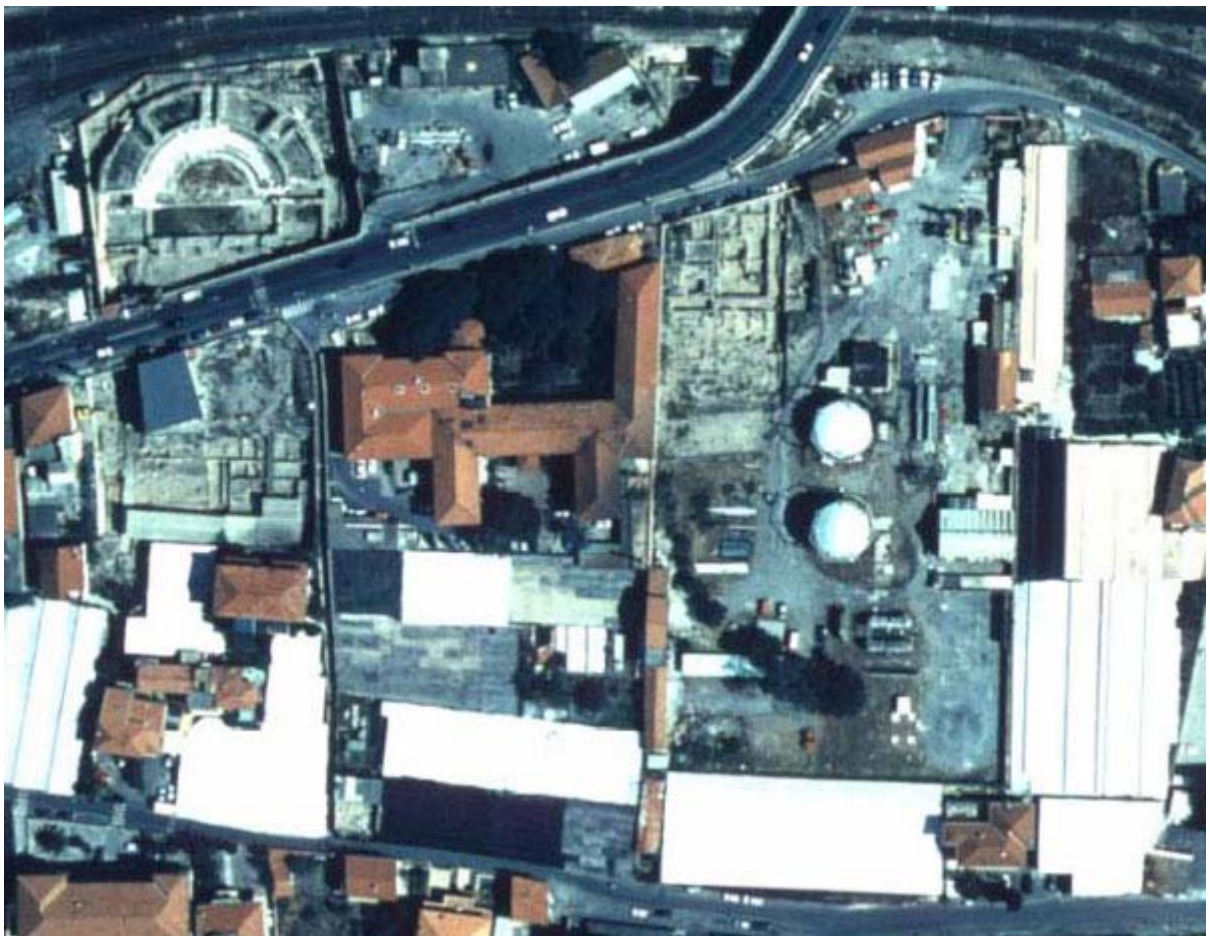

Aerial view of the area of intervention

The area of intervention is placed in Ventimiglia, a city located in the extreme west of the region of Liguria, on the border with France.

Ventimiglia, formerly Albintimilium, dates back to the Roman Republican age, presumably between the end of the II and the I century BC.

The city was probably destroyed in the fifth century AD and was gradually abandoned.

The first excavations in the area date back to 1877 by Girolamo Rossi and are currently carried out by Dr. Gian Piero Martino, an official of the *Soprintendenza Archeologica* of Liguria.

Project

Each path provided by the project could be seen as the search of the “lost steps” of travelers who have passed through Albintimulium during the centuries, an emotional visit that offers a different way to look at archeology.

In that way, every site could become a pretext for a literary narrative and at the same time, the space for the "experimental" architecture.

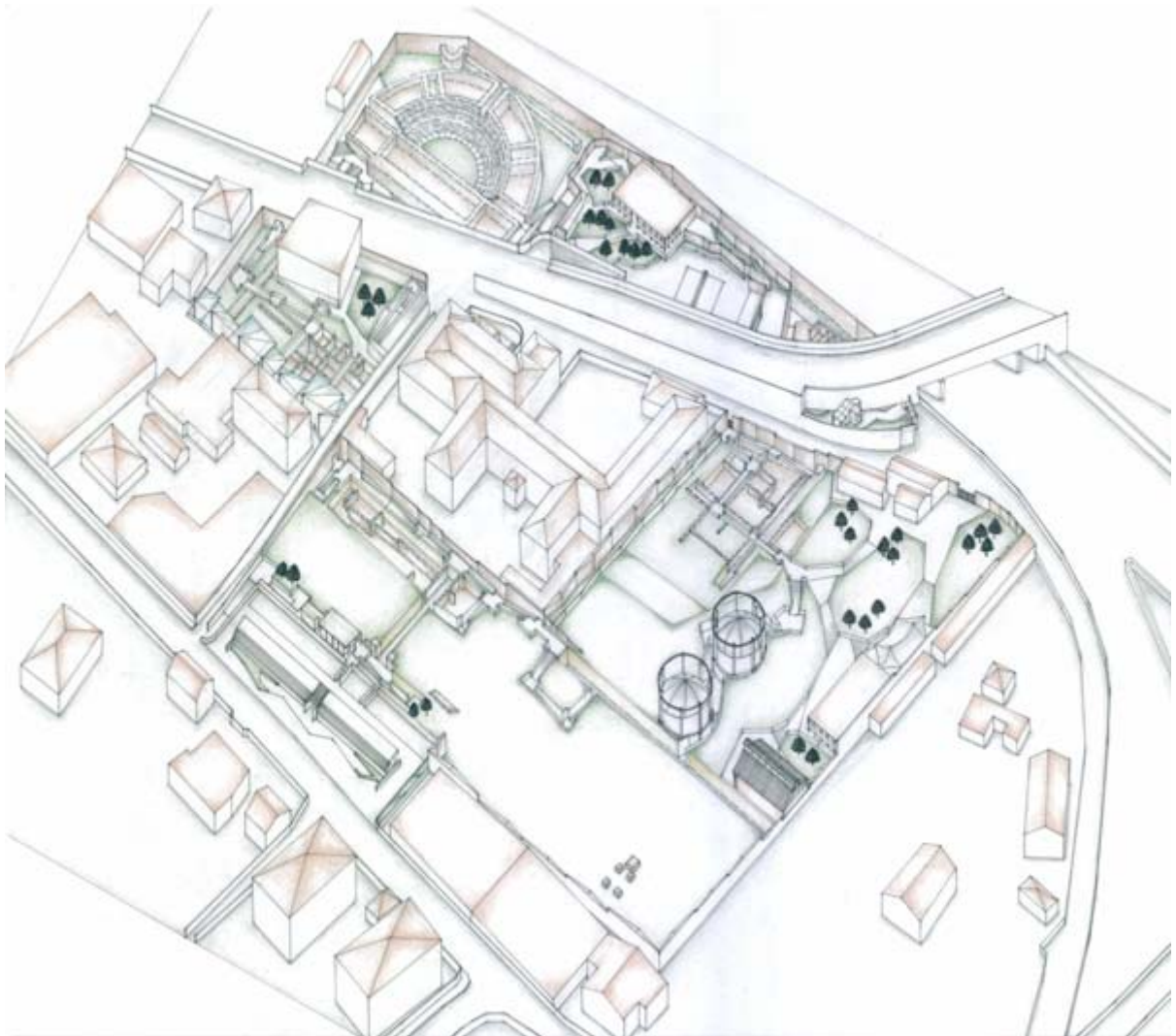

General Axonometry

The project area has a size of approximately 23,900 square meters.

The course is meant to link the various archaeological sites, constituting a clear and easily identifiable path that allows at the same time proper use of excavation and ensuring the existence of a real archaeological park.

The project begins with a study on the viability, as indicated by the NTA of the PUC current, with an enhanced circulation due to the implementation of a dual carriageway in via Nervia.

This allows me a more private and secure access to the park than the one located on Corso Genova.

Next to Via Nervi there is Porta Marina, that originally served as a link between the city and the sea: nothing seemed more appropriate than beginning the journey from here.

Close to Via Nervia I have designed a parking facility, which allows via ramps to reach the Info-Box / Bookshop, where the journey begins.

Following the path indicated the visitor arrives at the first part of the Baths.

The route has a main track but there are often areas that allow more freedom and space to curiosity.

Thanks to a short underpass, built under Vicolo del Pino, the visitor can enter the second part of the Baths and Antiquarium.

Reusing the existing underpass beneath Corso Genoa during, the visitor passes directly from the spa to the Theater.

In the theater there are two paths: one studied for the disabled people and one not easily accessible by them.

The first provides some ramps that allow you to see the Theater from above while the second allows, through a series of stairs, to get inside it.

From this second path the visitor has two choices: either go to the bar / dining facilities connected to the parking or continue the tour.

The tour continues in large part on an important decumano: the ancient Via Aurelia.

Then the visitor goes to the Domus and then, thanks to the long underpass built under current Genoa, can reach the insulae.

From the Insule he can go to the local didactic exhibition at the Lab / Warehouse, the conference hall and then go to the cabins of the gas, where, reaching the other decumano, the viewer is led towards the end of the trail and towards the parking.

For further information, e-mail:

Valentina Bruno: valentina.bruno@cheapnet.it