

# GET WIND OF

This pavilion was born after a long research about the senses and what there is over this concept.  
The words **perception**, **research**, **discovery**, **self-control** were the basis for this project.

There is a **simple geometry**, inspired by the historical concept of constructed. The walls are made of a thick metal mesh that catch humidity, water and snow, that will **gradually freeze**, creating a **permeable visual barrier**. Above all a **protection from the winds**, which goes to increase the more we enter into the structure. This phenomenon adds another sense, the **temporal element**, the mutation due to the surrounding environment.

From the outside you cannot see inside the internal circumference, except from a chink that looks towards a mirrored surface, that shows you the same “wall”.  
To discover the inside **you must go inside**, and explore the interior.

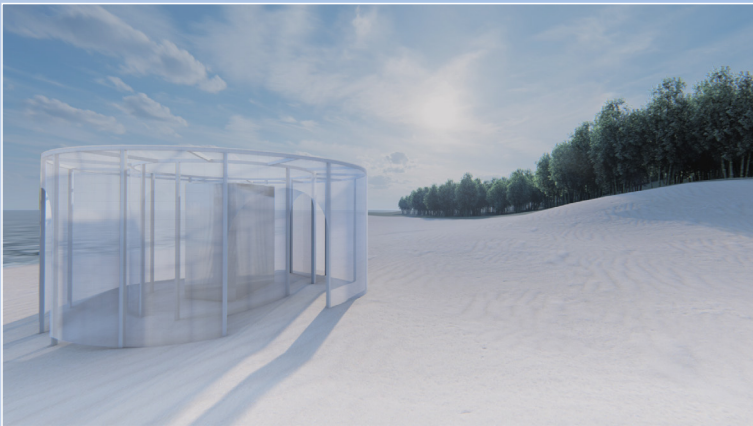

view of a sunny weather

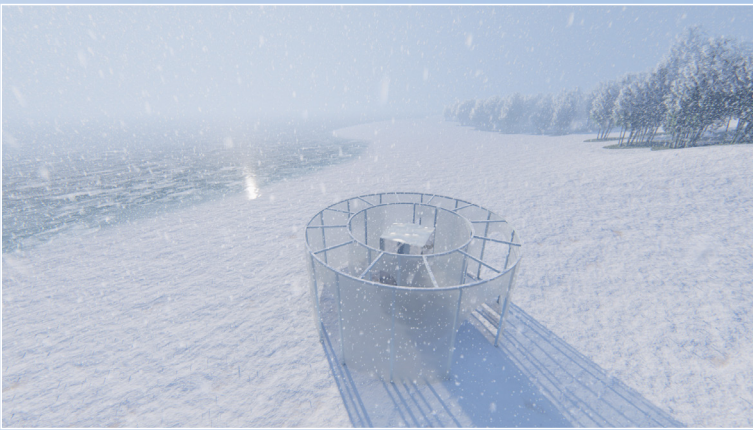

view of a snowy weather

## VISUAL PERMEABILITY

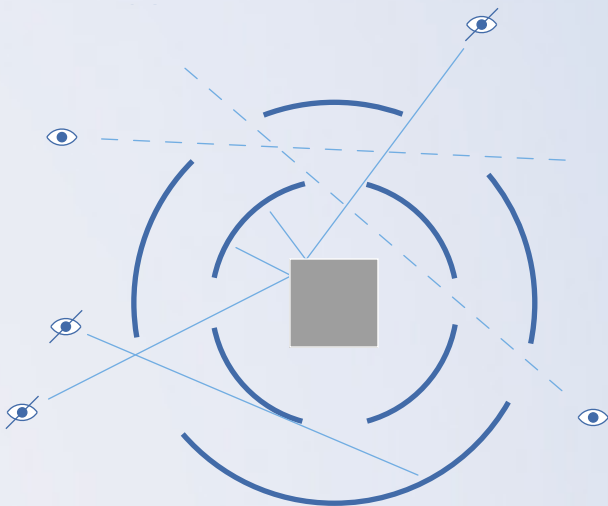

## WIND BARRIER

