**DESIGNING THE DISTANCES OF THE SPACE IN BETWEEN.
THE PLAYGROUND DESIGN AS A NEW URBAN TEXTURE TALE.
TORINO**

by Viola Gesmundo
Tutor: Massimo Crotti
Co-tutor: Alessandro Armando

The thesis deals with the issue of playground design, and focuses on its relations with urban transformations taking place in Turin; in particular the new university campuses that have been rising during the past two decades.

The thesis is based on the consideration that the design of the ground is the starting point to reshape the public open space.

Designing the soil allows to act on the fragmentation of the urban pattern, starting from the spaces between the buildings, to connect it.

The thesis analyses a specific part of the city, the “archipelago universitario” (university archipelago): it includes the historic university area around Palazzo Nuovo, the university hubs along the historic road of Via Verdi, and the new Campus Einaudi with the adjacent university residences along Dora River. The aim of my project is to implement a network that links the new and the old university hubs. The research focuses on the built environment and its relation with the open spaces surrounding it.

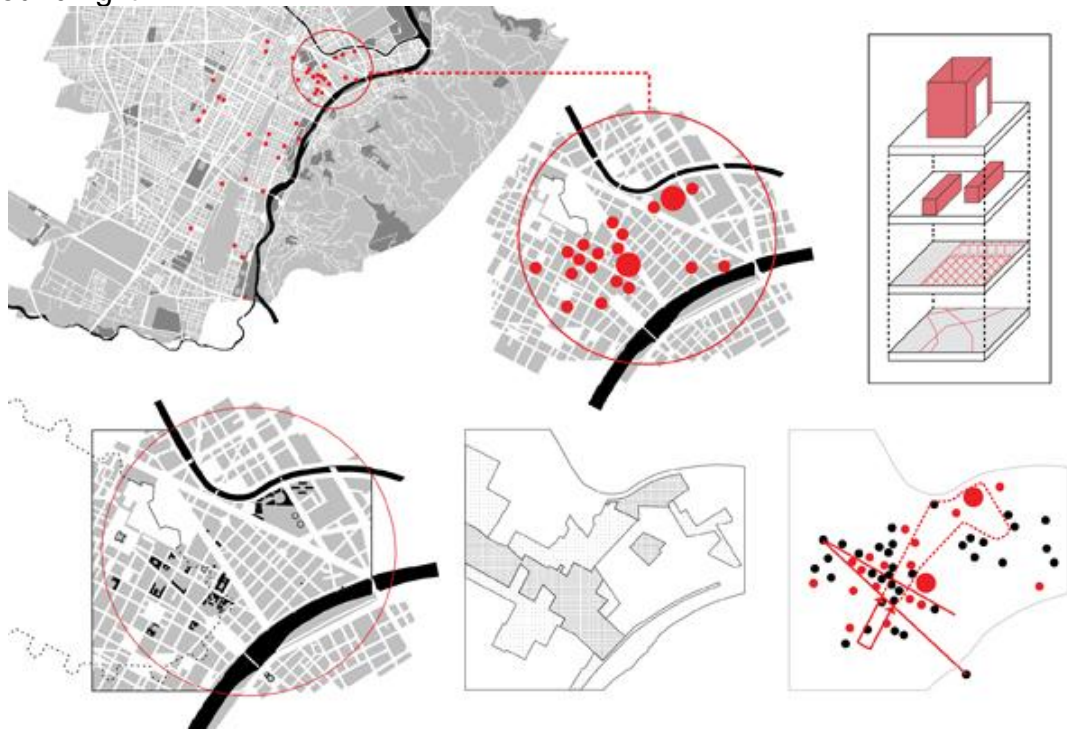

University archipelago's settlement and analysis graphs on the same part of the city. The diagram on the right shows the four analysis layers of public space and therefore the re-designing areas: mobility and accessibility, floor materials, urban furniture and the activities on the ground level

Moreover the final output of the analyses is an abacus: it connect the different public spaces that need to be implemented, the buildings facing them, and the types of stones that have been used among the centuries in Turin. These stones are likely to be used to design the soil in specific areas, considering at the same time a comprehensive vision of the design strategy. Therefore the project consists on the re-use of existing stone materials.

As a result the ground appears as a recombination of the existing urban fabric, giving it new meanings and shapes: this is the theoretical and methodological background both in the research and in the design phases of the thesis. Furthermore the analyses is intended to make a reflection on the heritage, including both abandoned buildings, open spaces, and soil materials.

Il **Magazzino Comunale della Pietra** (City warehouse of stone) in Turin, owned by the Municipality, contains a big amount of stone materials and urban furniture. These are leftover and extra materials coming from public space transformation processes. It has not been possible to take advantage of the potentials of all this waste materials because none of them is archived nor counted, even if some of the stones date back to Roman times.



Pictures taken during April 2014 inside City warehouse of stone in Turin: granite pavers of Alzo and medium and big slabs of Luserna belongs to public space dismantling and they can be reused in the public space

The thesis is meant to underline the potentials in reusing these materials to implement the spaces in between the buildings and encourage the pedestrian and bicycle mobility.

First, I analyzed four levels that have emerged during the research process, starting from the fragmentary nature of the soil in the university district in central Turin. These levels are the ones that guided the design phase: mobility and accessibility, floor materials, urban furniture and the activities on the ground level.

Secondly, the design phase identifies the main types of paths and nodes that structure the university archipelago. The consequent action consists of sewing them up with a “fil rouge”: this acts as a metaphorical connection of the urban life in public spaces involved in the project. In the meanwhile it is a physical ribbon too, that recomposes the public ground and facilitates orientation for its users.

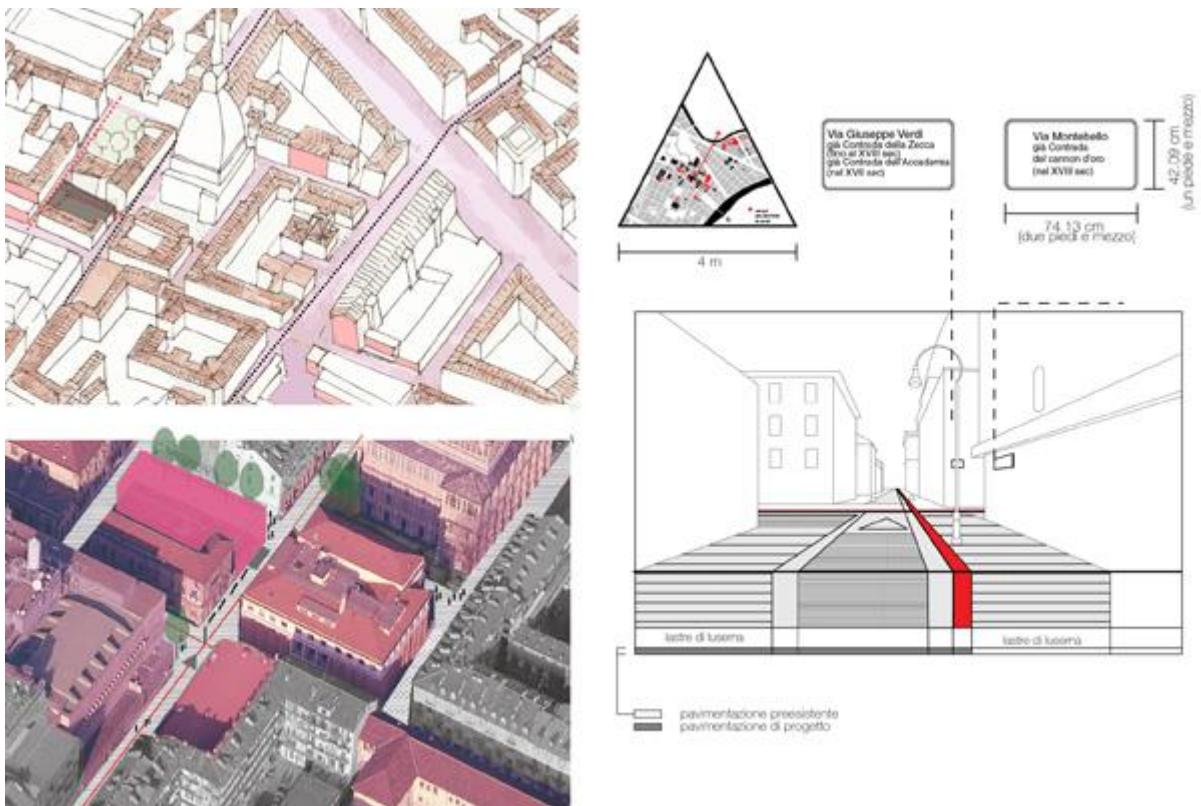

Drawings, photomerge and example of a redesigning of the central historic area near the university hub, between Via Verdi e Via Sant’Ottavio

First, the “fil rouge” is paved with the stones previously mentioned, repainted in red; In this way the paths connecting the universities and the open spaces would be easily recognizable and it would encourage the social relations between inhabitants, retailers and students. Secondly some different stones used as signals will be embedded in the path. Furthermore some big Luserna stones will mark the entrance of important buildings, and will be used as maps and signals engraved in vertical stone totems in places of public interest.

As a result the city will talk to the students, citizens and tourist and will guide them across public spaces and places of interest.

This work is the result of a collaboration between the candidate and the Turin City Council Urban Furniture, Urban Regeneration, Mobility and Infrastructure sections and the City warehouse of stone.

Thesis online Issuu:

http://issuu.com/violagesmundo/docs/tlm_progettare_percorrenze_viola_ge/1

For further information, e-mail:

Viola Gesmundo: viola_ges@hotmail.it

Linkedin profile: <https://www.linkedin.com/pub/viola-gesmundo/6b/b33/676>

Maintained by:

DAD – Department of Architecture and Design, e-mail: dad@polito.it