

Il Tempo delle Muse

Architetture dell'effimero e strategie di valorizzazione
tra moda e patrimonio a Villa Adriana

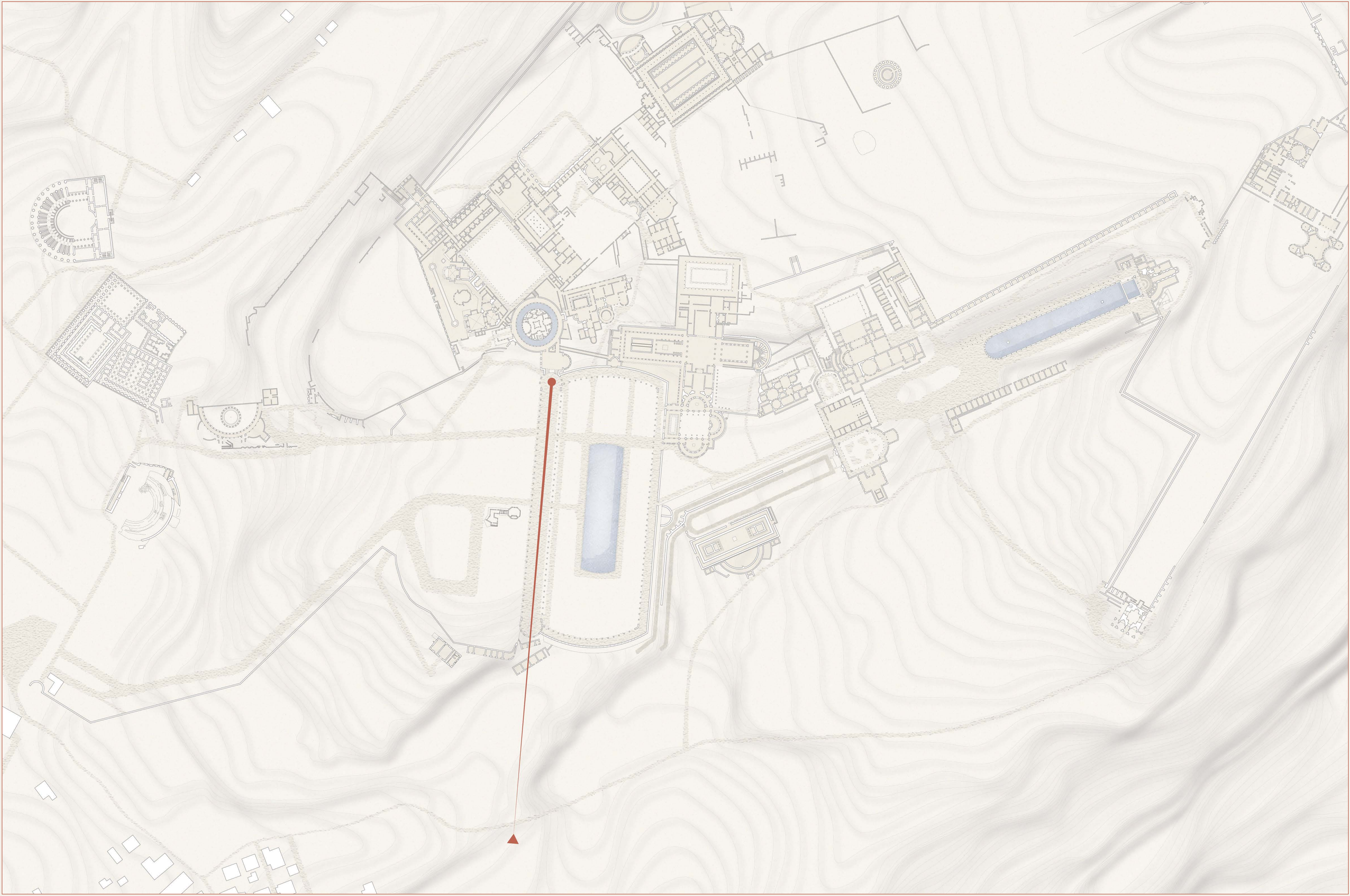

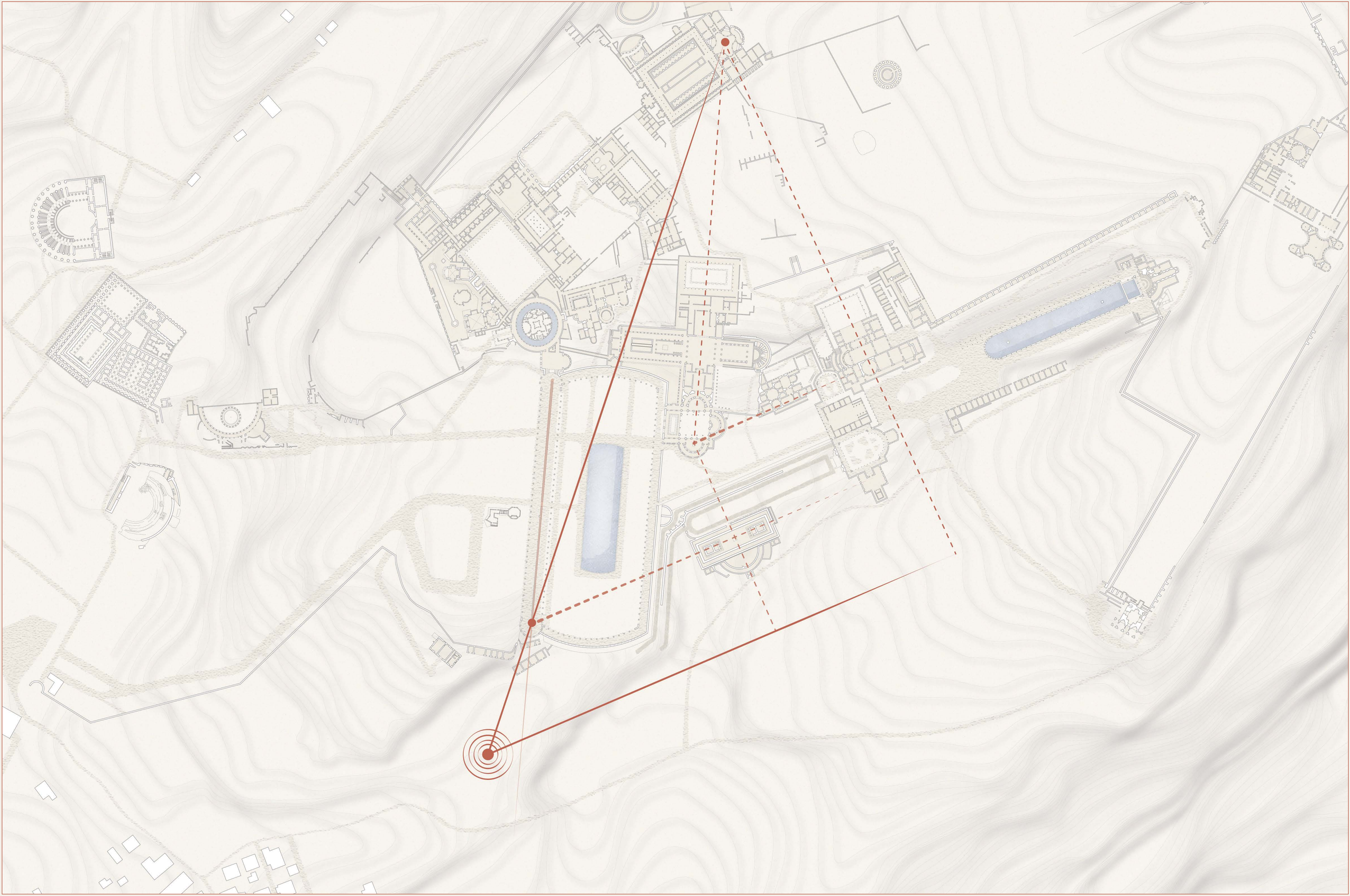







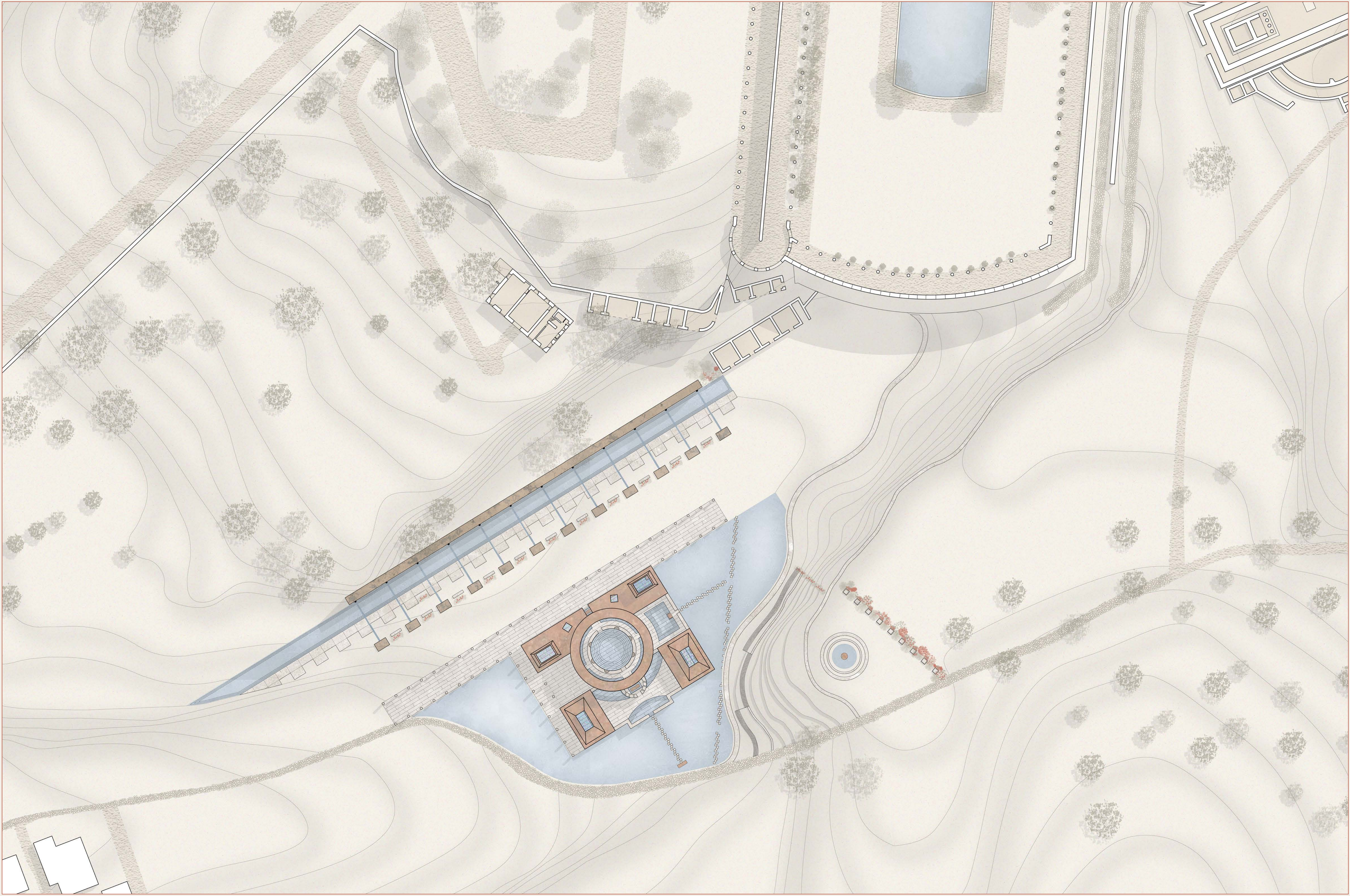

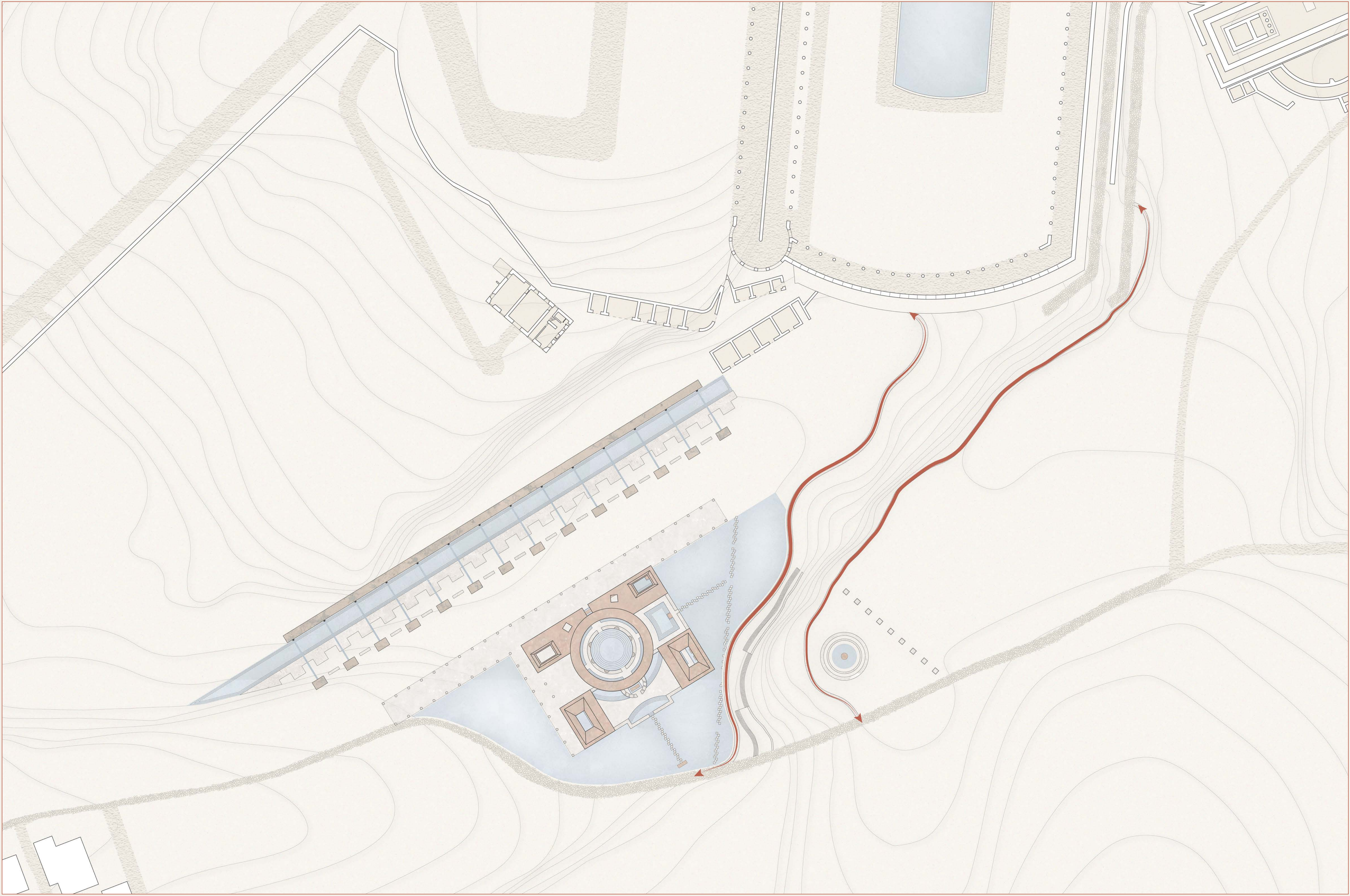

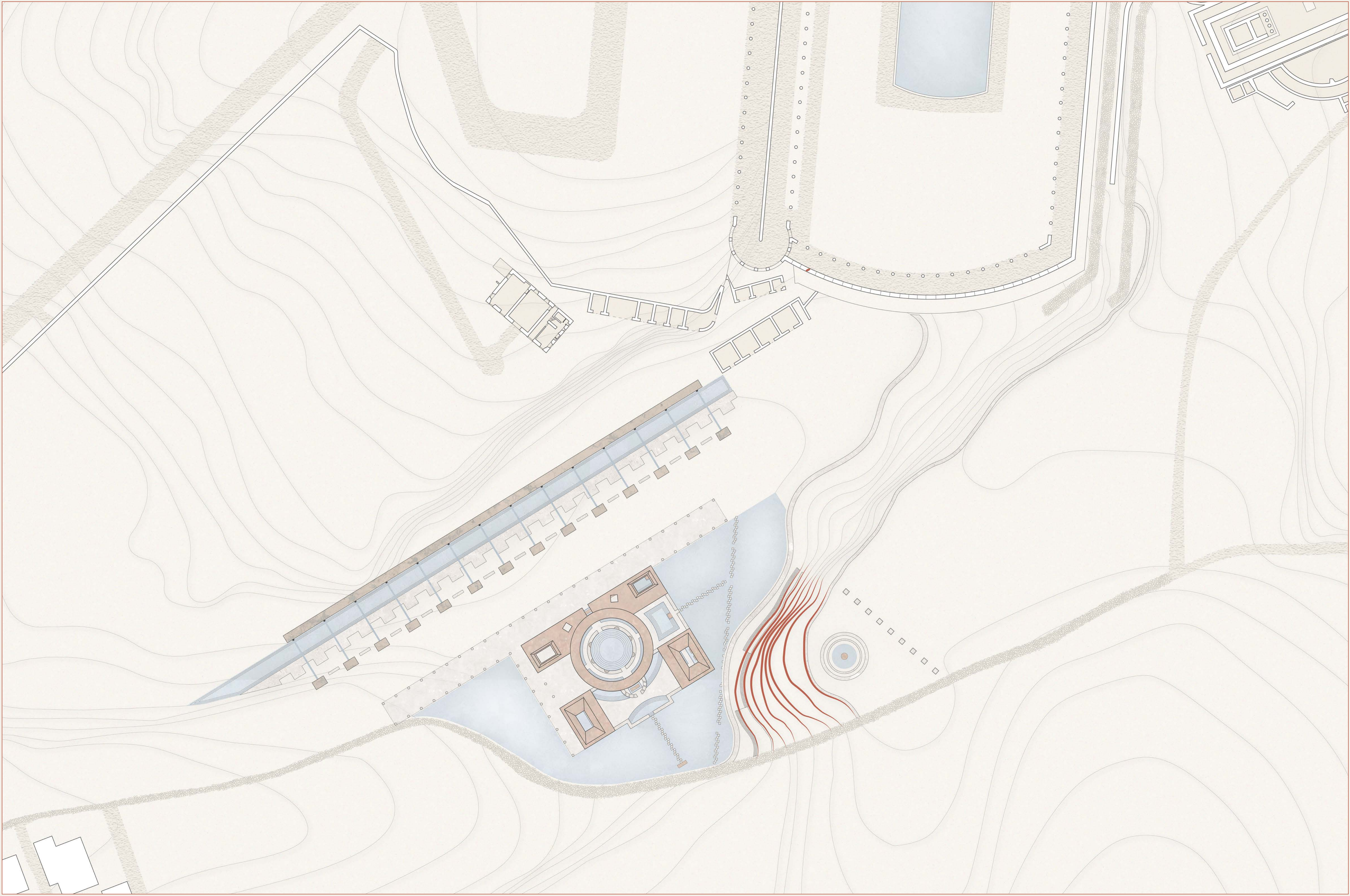



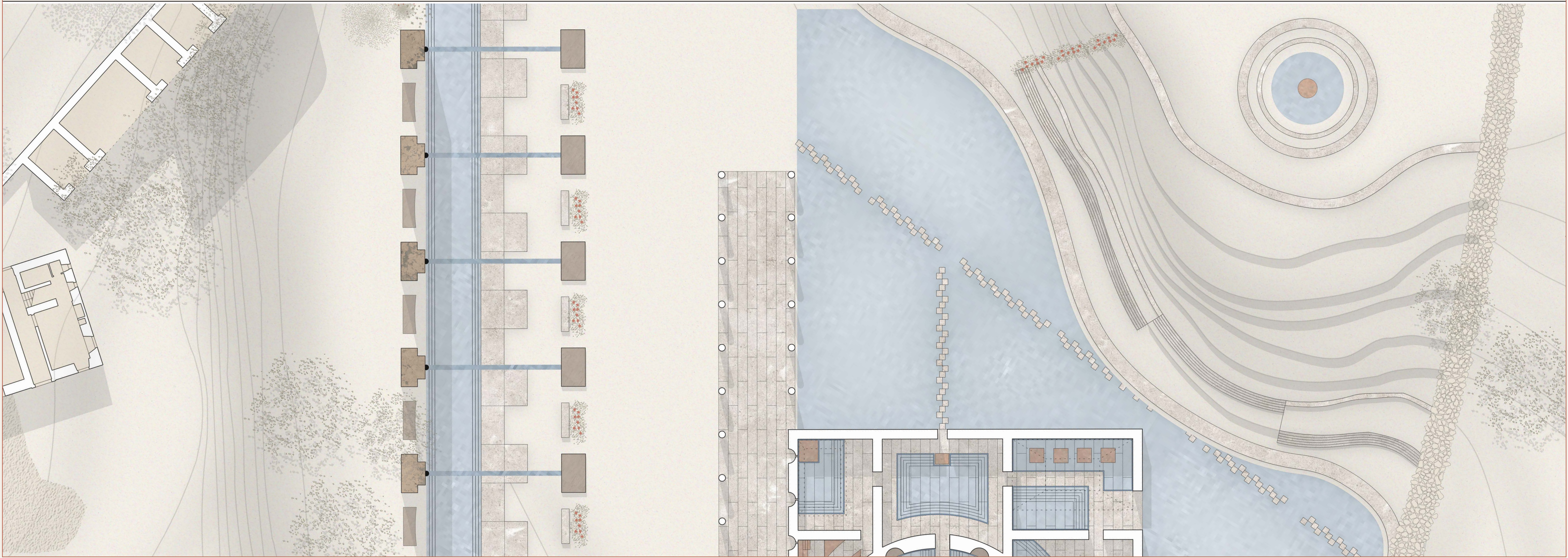
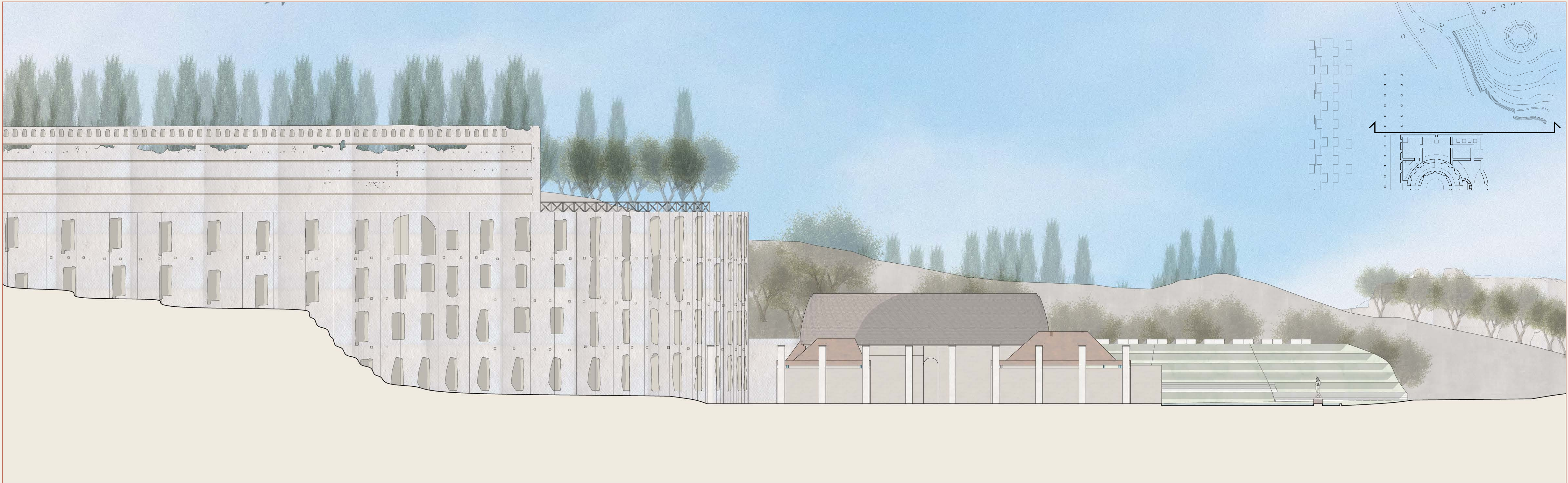

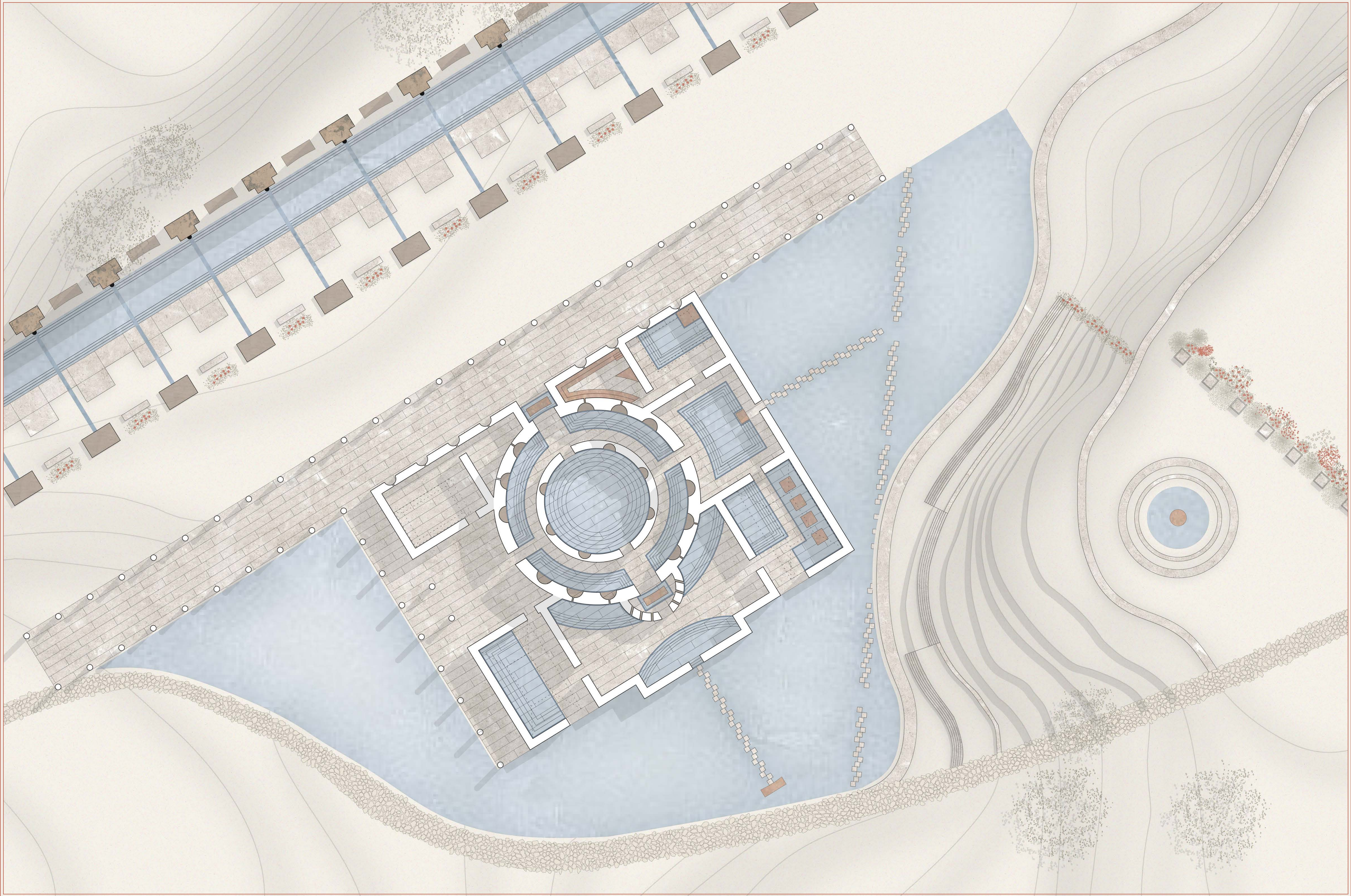

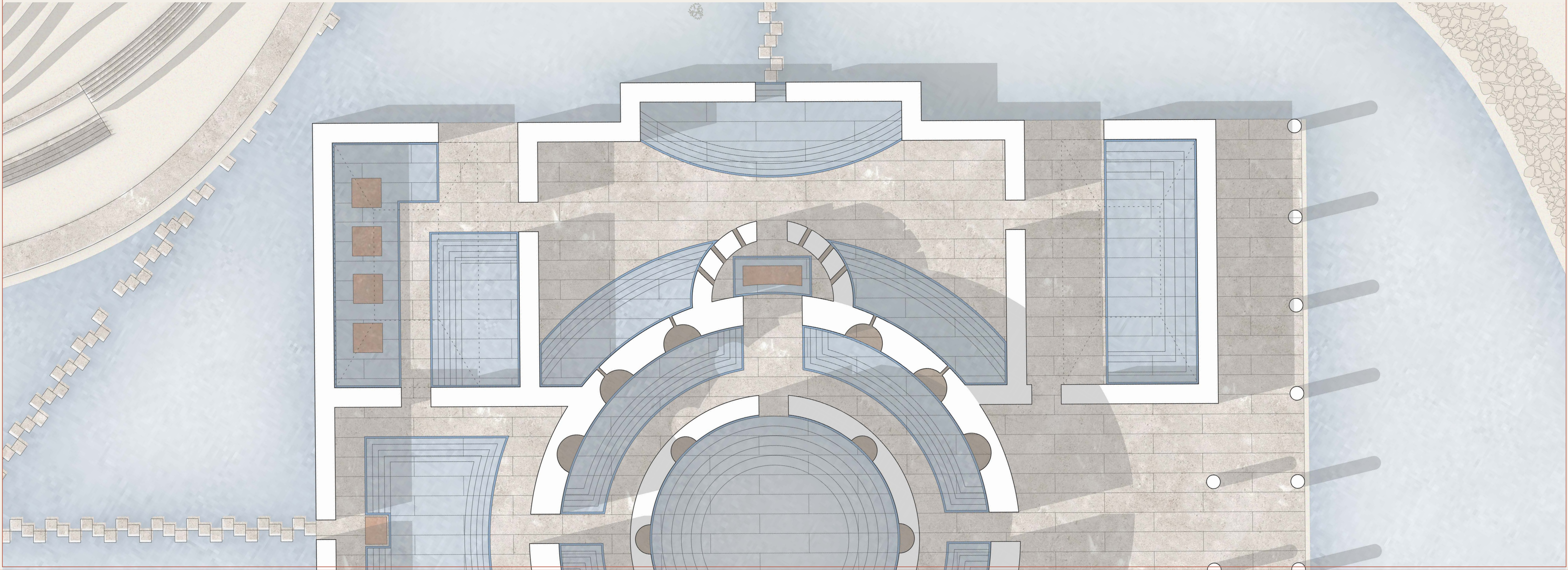

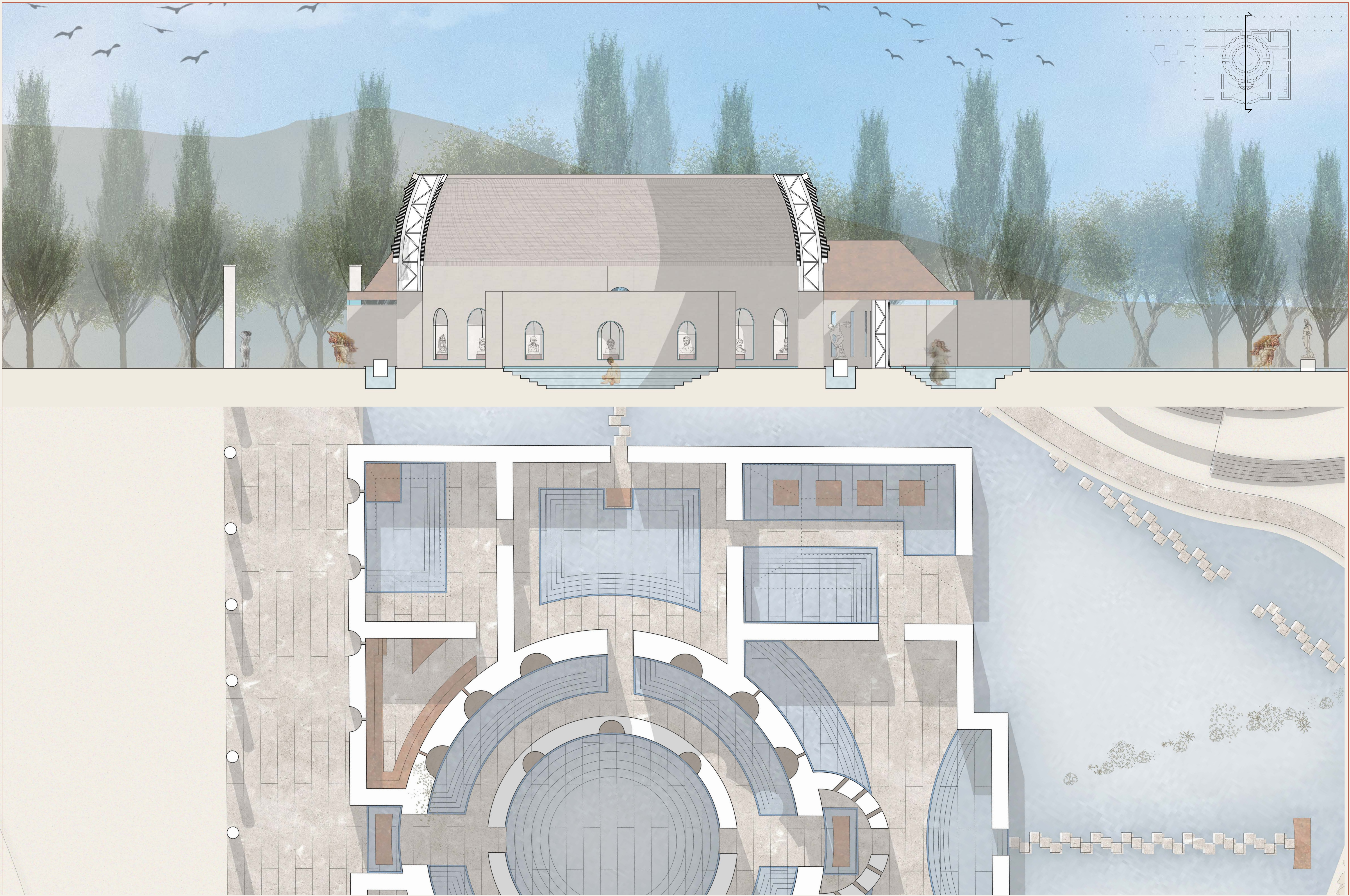

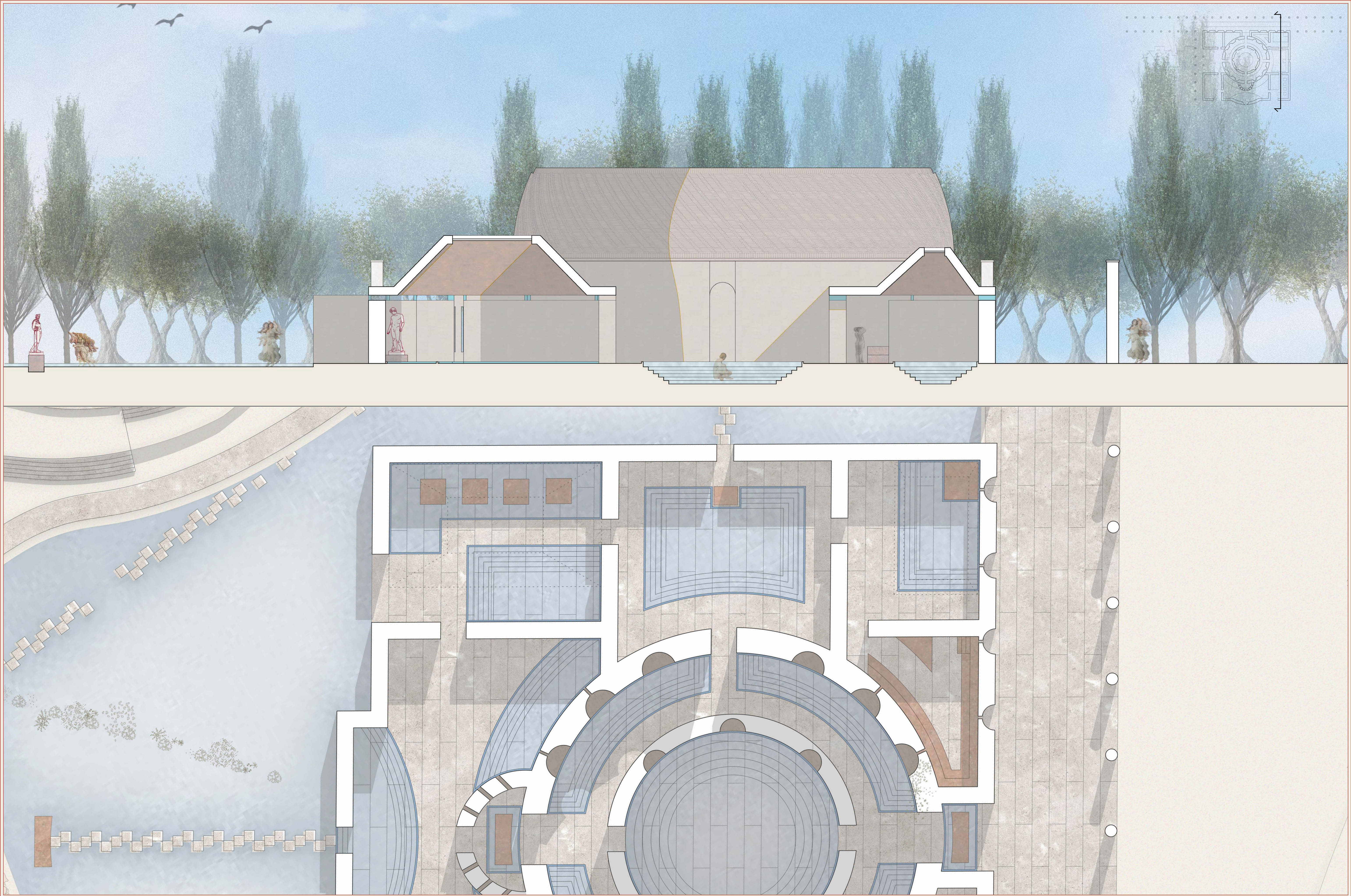



Amore e Psiche
(Antonio Canova - 1788/1793)

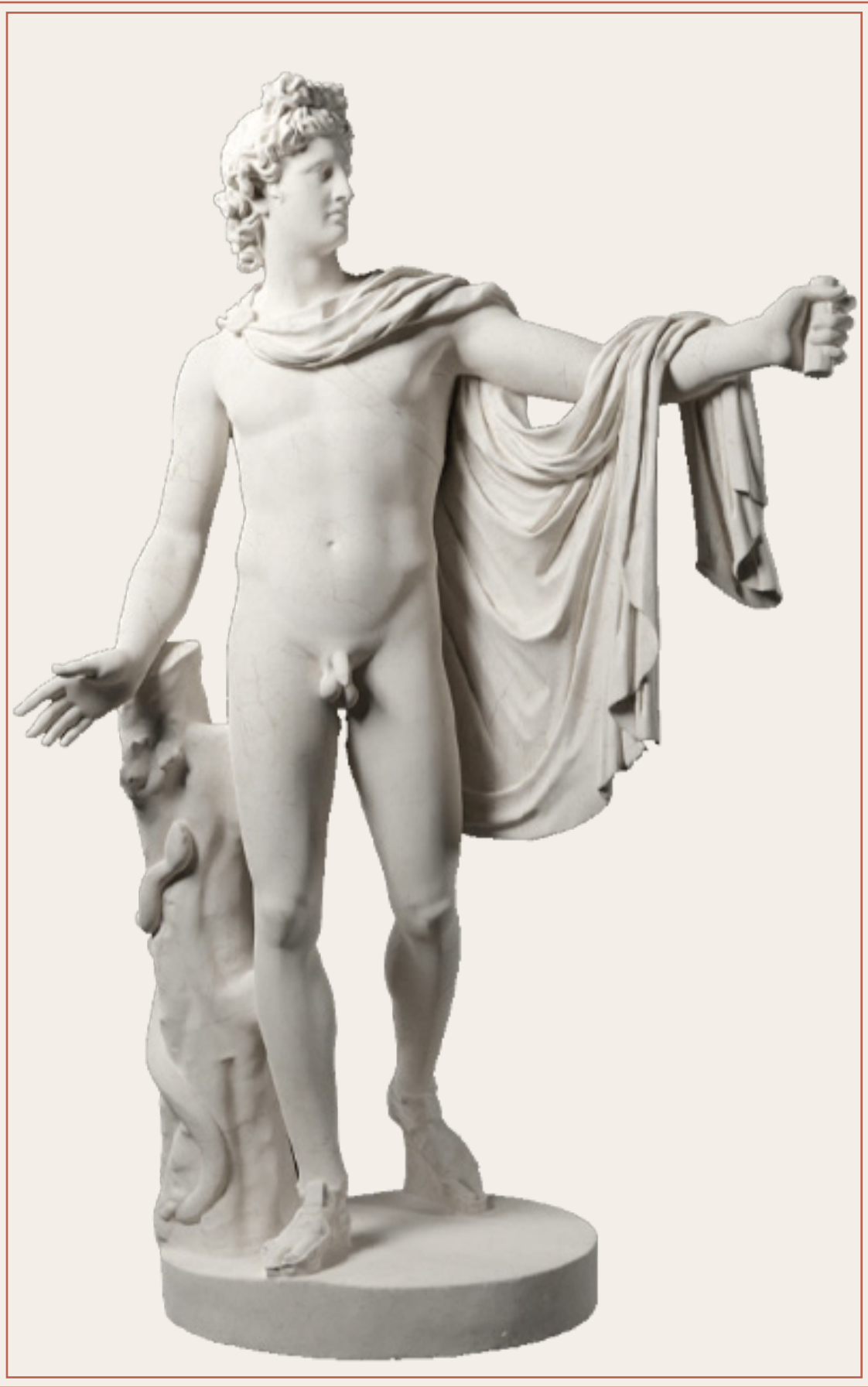

Apollo del Belvedere
(Leochares - 330/320 a.C.)



Discobolo
(Miron - 455 a.C.)



Nike di Samotracia
(Sconosciuto - 190 a.C.)



Fauno Barberini
(Sconosciuto - 220 a.C.)



Ercole e Lica
(Antonio Canova - 1795/1815)



Doriforo
(Policleto - 440 a.C.)



Augusto Prima Porta
(Sconosciuto - 20 a.C.)



Nike di Samotracia
(Sconosciuto - 190 a.C.)



Torso del Belvedere
(Apollonio di Atena - I sec. a.C.)













