

POLITECNICO DI TORINO  
FIRST SCHOOL OF ARCHITECTURE  
Master of Science in Architecture (Construction)  
***Honors theses***

---

**LIAISON DE LA VILLE: proposed post industrial urban in area Ivry sur Seine**

by Andrea Pizzolla and Barbara Squillari

Tutor: Pierre Alain Croset

Co-tutor: Agata Spaziante

Chapters:

- ***Introduction***
- ***Brownfiel sites***
- ***Paris Rive Gauche***
- ***Preliminary study***
- ***Urban project***
- ***Project description***
- ***Study of housing typologies***
- ***Conclusions***

The redevelopment and reuse of brownfield sites in Europe, is a highly topical issue.



The first approach to this new project has been well studied, the various maps and plans, take the first contacts and above all understand how you can destroy a part of the city to make it better. The thesis proposes an object of study, the city of *Ivry sur Seine*, starting with an analysis of the context of the relationship between *Ivry sur Seine* and Paris. The interpretations can be numerous, and certainly the relationship between housing, services and industrial side of the city should stand firm. The request is to create a green city, with no vehicular traffic, where ecology maintains an important place. These points are fundamental, but no infrastructure to connect to these new parts of the city and the creation of a sustainable city from the environmental point of view, you probably would again have the problems existing in the area. The above area is one - fifth of the municipal area between the River Seine and the beam of Austerlitz railway.

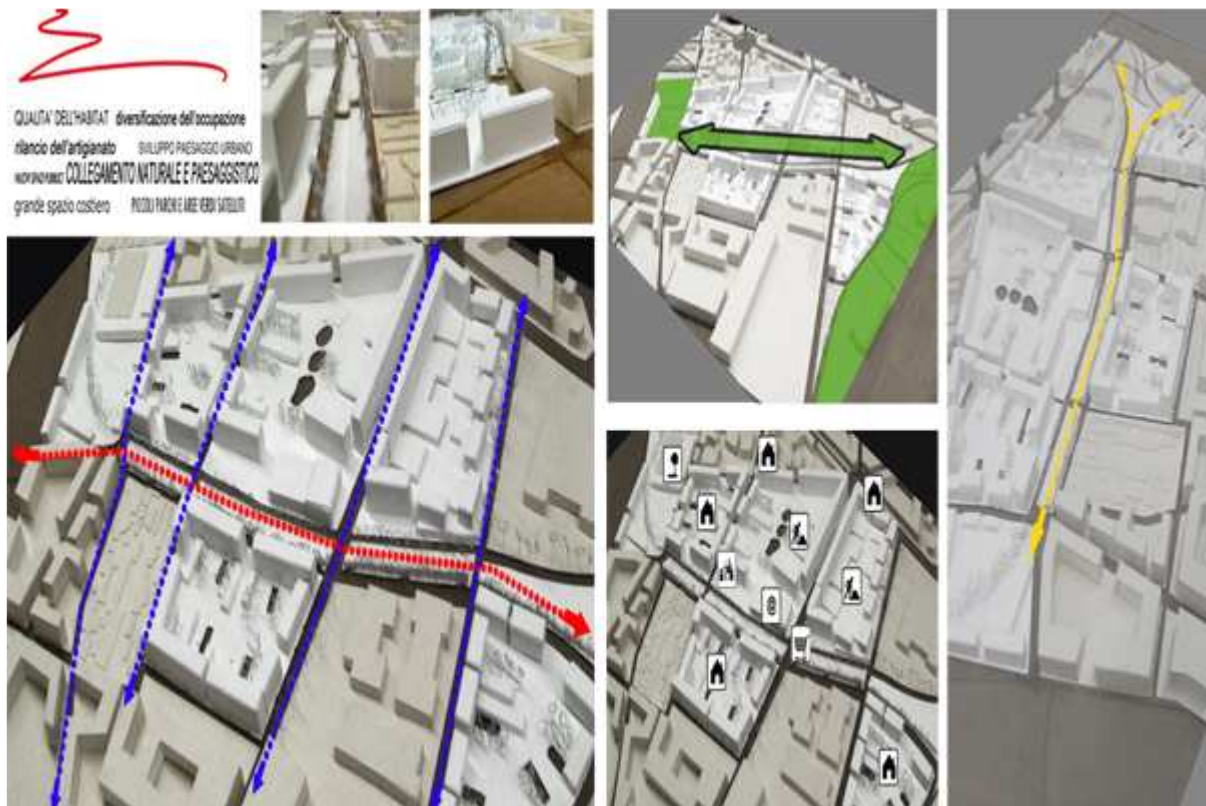

The municipality has chosen to actively involve residents in decisions made through meetings, focus groups and educational activities carried out on different age groups in order to understand what are the current shortcomings of the city and jointly tackle its design.

In the paper "Vers Ivry 2015" is denoted as the city has three main objectives: to improve the connection between the natural and scenic river and the fort, located on the 'plateau, the creation of a large coastal park to replace the walk along the Seine, and finally the inclusion of small parks and green spaces in urban satellites arranged in connected routes.

The ultimate goal is to define the role of the new axis of the strong link between the city located in the hilly area and the urban park positioned on the banks of the Seine. During the analysis identifies weaknesses and strengths of the master plan for the proposed project from the Paris studio of Bruno Fortier and possible counter to it. The project navigator becomes green infrastructure for the population of the city public with the purpose of connecting a slow walk through the two new parks created. One of the two parks is in direct correlation with the extent of the rail network, while the other is related to the river Seine, giving rise to various dimensions of the city: the louder the "Rambla" and the quietest interior of any isolated as semi-public. The project is to insist on an 'area of major environmental and strategic, marred for years by the presence of the industrial area, at today' s obsolete, whose conversion to other uses remains a source of great debate.

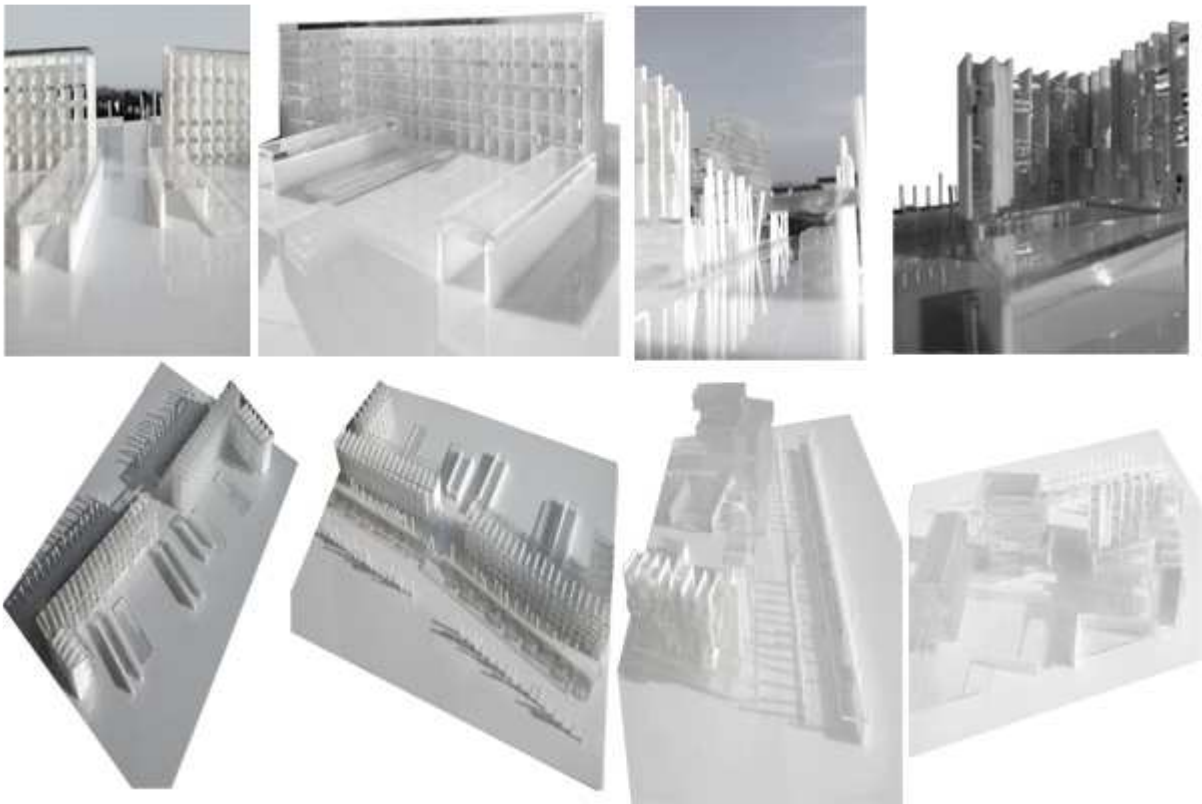

The thesis, secondly, the analysis of the intervention goes to the neighborhood scale, and then continue with the 'identification of future settlement principles. Outlining new reference models that are based on several reports of residence with the semi-public park and the new buildings for primary processing.

These models are calibrated with the specific morphology of each block, outlining their connotation with those that have the characteristics of the context in which they settle. Well then an intervention that fulfill the search for dialogue with the landscape, the environment and the context, and that can mostly meet the current and future needs of the city.

For further information, e-mail:

Andrea Pizzolla: [magicopizz6@hotmail.it](mailto:magicopizz6@hotmail.it)

Barbara Squillari: [boorby@hotmail.it](mailto:boorby@hotmail.it)