

Dettaglio 1

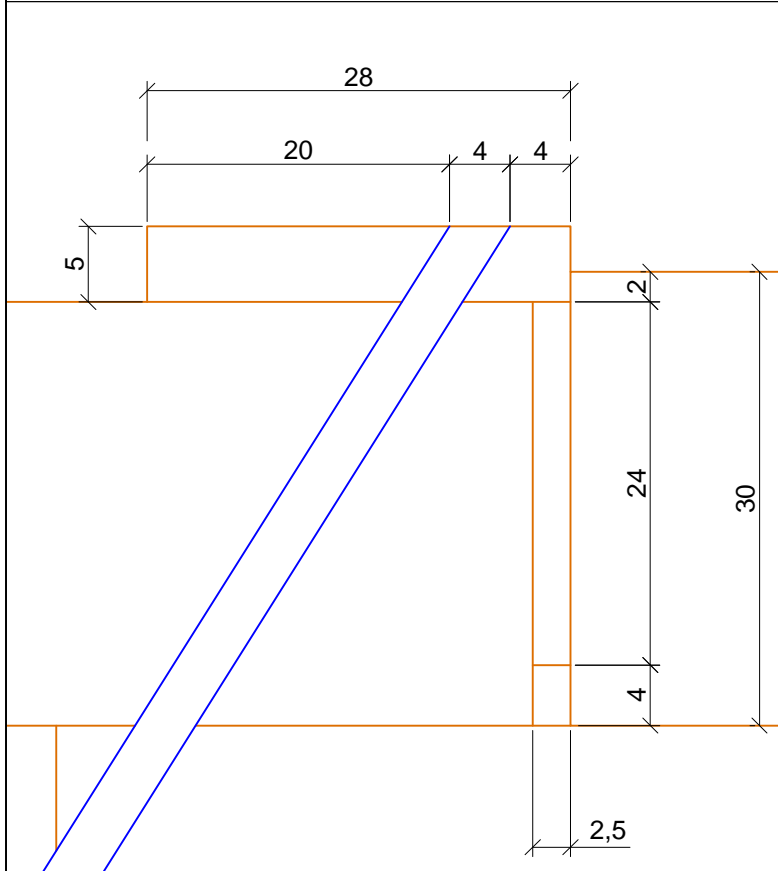

Dettaglio 2

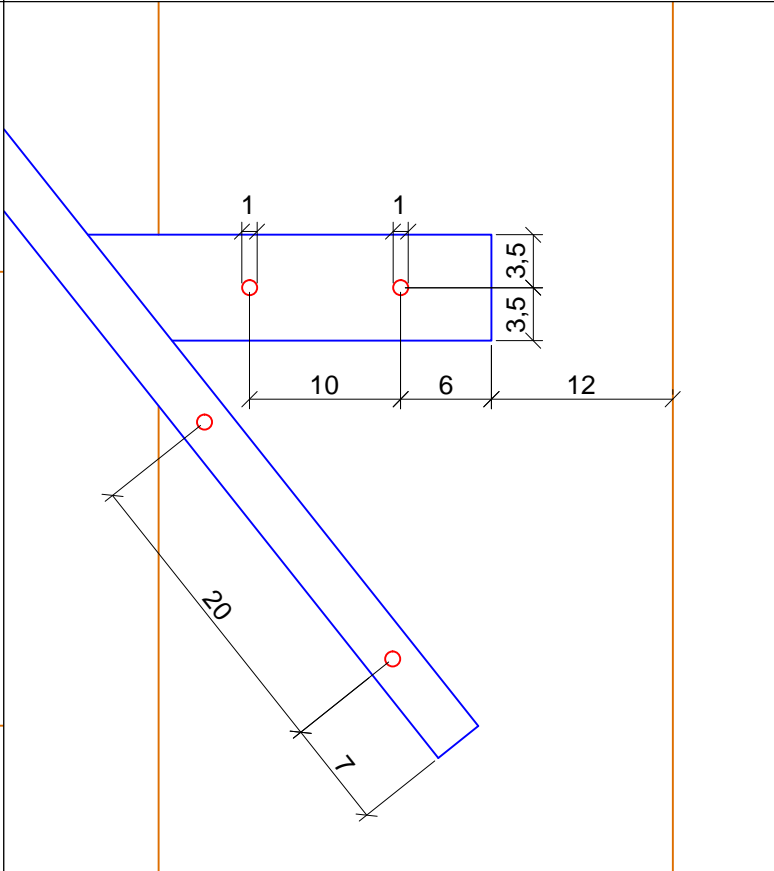

Dettaglio 3

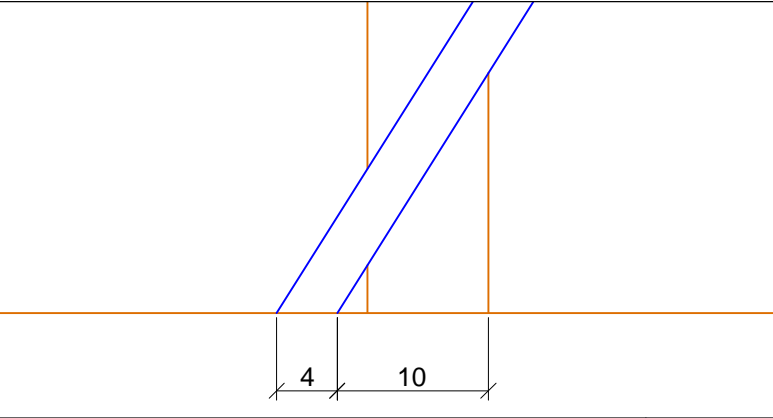

Dettaglio 4

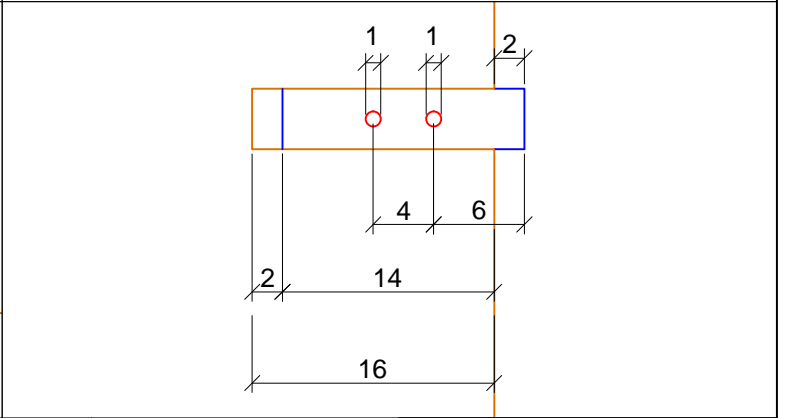

Tesi di Laurea Magistrale in Ingegneria Civile	Tavola N°: 5	Scala 1:20 e 1:5	
Monitoraggio Strutturale con la Tecnica delle Emissioni Acustiche della Torre Campanaria del Duomo di Torino	ALLEGATO 5: Dettaglio Ritti P3 e P4		
Studente: Perrone Antonio 238903			
Relatori: Prof. Carpinteri Alberto Prof. Manuello Bertetto Amedeo Ing. Masera Davide			
			16/12/2019



16/12/2019